

SMMAFund

RECOMMENDATION FORM

The SMMAFund Scholarship Program reflects SMMA's commitment to the communities it serves, demonstrates SMMA's belief in higher education, and supports the design professions. The program provides financial assistance to high school seniors in the form of scholarships awarded for their continued education in a field of design that contributes to the built environment. **Eligible applicants must plan to enroll in an accredited, not-for-profit, educational institution in the United States to pursue study in Architecture, Landscape Architecture, Interior Design, or one of the following engineering disciplines: HVAC, Electrical, Plumbing, Fire Protection, Structural, or Civil.**

Please assist the SMMA Fund Scholarship Committee by providing your insights into the applicant's activities, accomplishments, and characteristics that position him/her for success. **Please complete this form and submit it by Friday, March 21, 2025** by email to hmcormack@smma.com or by mail to: SMMA, 1000 Massachusetts Avenue, Cambridge, MA 02138, Attention: Heather McCormack.

Applicant's Name:

Applicant's Address:

Applicant's High School:

1. Tell us how long you have known the applicant and in what capacity.

SMMA Fund

RECOMMENDATION FORM

2. Help us understand the applicant's likely success in higher education and the design professions by rating his/her demonstration of the following attributes and providing comments as you wish.

Rate on a scale of poor to excellent.

<u>Attribute</u>	<i>poor</i>	<i>fair</i>	<i>good</i>	<i>very good</i>	<i>excellent</i>	<u>Comments</u>
Leadership	<input type="checkbox"/>	<input type="checkbox"/>	<input type="checkbox"/>	<input type="checkbox"/>	<input type="checkbox"/>	
Creativity	<input type="checkbox"/>	<input type="checkbox"/>	<input type="checkbox"/>	<input type="checkbox"/>	<input type="checkbox"/>	
Collaboration	<input type="checkbox"/>	<input type="checkbox"/>	<input type="checkbox"/>	<input type="checkbox"/>	<input type="checkbox"/>	
Initiative	<input type="checkbox"/>	<input type="checkbox"/>	<input type="checkbox"/>	<input type="checkbox"/>	<input type="checkbox"/>	
Enthusiasm	<input type="checkbox"/>	<input type="checkbox"/>	<input type="checkbox"/>	<input type="checkbox"/>	<input type="checkbox"/>	
Dependability	<input type="checkbox"/>	<input type="checkbox"/>	<input type="checkbox"/>	<input type="checkbox"/>	<input type="checkbox"/>	

3. Provide any other information or observations about the applicant that might assist the committee in its deliberations.

Printed Name:

[Redacted]

Email Address:

[Redacted]

Phone Number:

Signature:

Date:

A Charitable organization established by the directors of SMMA to support the communities that SMMA serves and the charitable activities of its employees.

Eligibility

The applicant must be a senior at one of the following high schools in Massachusetts:

Ayer-Shirley
Bedford
Bridgewater-Raynham
Chelsea
Dennis-Yarmouth
Douglas
East Longmeadow
Grafton
Hudson
Lexington
Lynn Classical
Marblehead
Mashpee
North Middlesex
Quincy
Somerville
Swampscott
Tewksbury Memorial
Turners Falls
Wakefield
Waltham
Wellesley
West Springfield
Winchester



Waltham High School

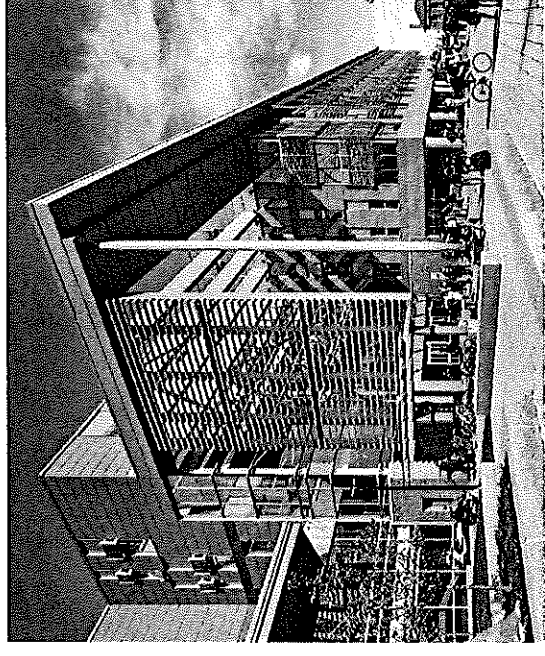

Somerville High School

Process and Criteria

Following a screening process, final selection will be based on academic excellence, clarity of goal, and professional promise.

To apply for this program, students must have the completed Application and Recommendation forms along with their school transcript sent to SMMA by the **Friday, March 21, 2025 deadline.**

Contact

Heather McCormack
SMMA
1000 Massachusetts Ave.
Cambridge, MA 02138
hmcormack@smma.com
617.520.9235

Forms

To obtain a copy of the Application and Recommendation forms, please see your Guidance Department or email Heather McCormack at hmcormack@smma.com.

Good afternoon,

At SMMA, we deeply admire Marblehead High School's mission to provide meaningful education to a diverse student population. As designers of your high school, we are inspired by your efforts and wish to support you in encouraging and rewarding deserving students.

To that end, we are pleased to announce the SMMA Fund, a charitable organization created to give back to the communities where we've designed high school facilities and to honor the design professions. Swampscott High School is one of 24 schools invited to participate in our scholarship program, which provides financial assistance to graduating seniors pursuing continued education in design fields that contribute to the built environment. Please refer to the attached SMMA Fund Information Sheet for a list of applicable design fields.

We hope that some of your students share our passion for design and look forward to supporting them as they pursue their educational goals.

We kindly request your assistance in making the SMMA Fund Information Sheet, Application, and Recommendation Forms available to eligible students, either electronically or in hard copy. Students must submit their completed application, recommendation forms, and transcripts to SMMA by **Friday, March 21, 2025**.

If you have any questions or need additional materials, please don't hesitate to reach out.

Regards,



Heather McCormack / she/her